

## MA Base UniSlide Assemblies

### A comparison of dovetail base style:

#### MB Style - the standard motorized UniSlide Assembly

- Includes protective internal limit switches, J.
- Base is stiffer than the MA style reducing the deflection of unsupported sections.
- Added height allows most units to lie flat on a flat mounting surface.

#### MA Style - the low-profile design UniSlide Assembly

- A more compact design with reduced slide height and weight. Base lengths available to 12".
- Compatible with steppers, AC synchronous motors and PM motors only. Motors extend below slide base.
- Outboard limit switches suggested unless used with NEMA 17 low torque motors.

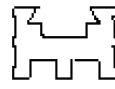

MB style

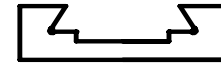

MA style  
UniSlide Assembly Bases

Series MA1500



## Series MA1500 Assemblies

### Description

These small, low profile positioners are for light duty applications with light loads. The MA1500 is available in four lengths. The maximum recommended step rate is 1000 steps/

sec. The base requires support along its full length except for the lightest loads (< 1 lb.). Way covers are not available. See page 6 of the Price List for MA1500 Series.

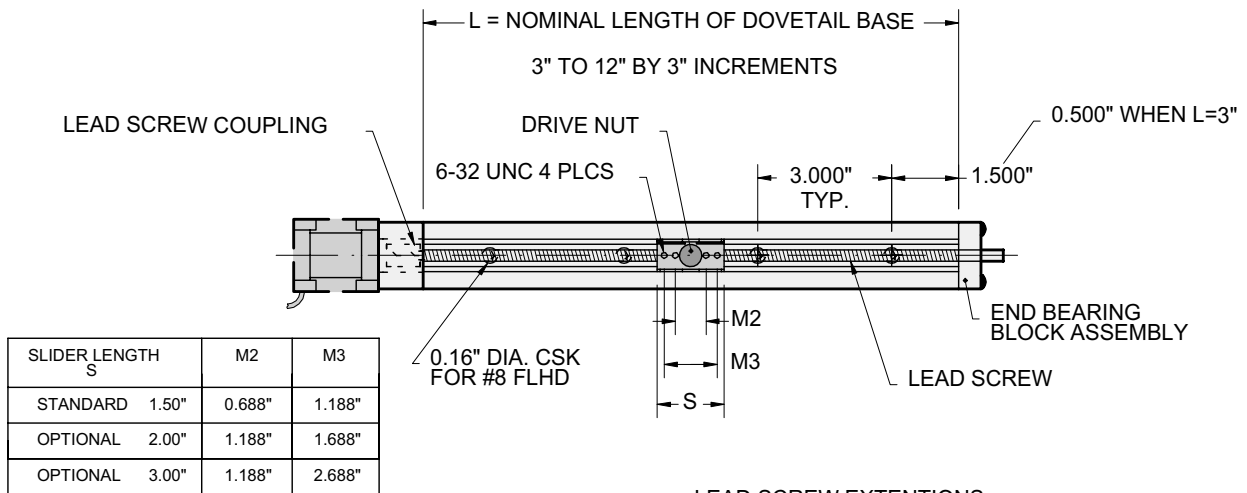

#### LEAD SCREW EXTENSIONS:

- 0.50" X 0.218" DIA. FOR B/P20 LEAD SCREW
- " 0.231" DIA. FOR C/P40 LEAD SCREW
- " 0.250" DIA. FOR K1,K2/Q1,Q2 LEAD SCREW

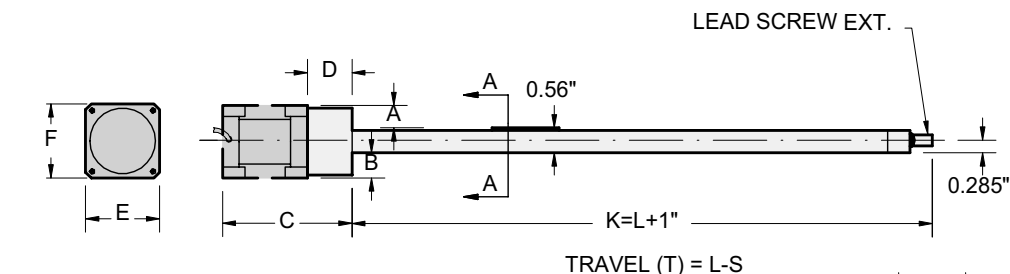

MOTOR TYPE	A	B	C	D	E	F
PITTMAN GM8000 SERIES	0.68"	0.14"	4.44"	1.15"*	1.5"	1.375"
STEPPER MOTOR NEMA 17	0.65"	.545"	2.85"	1"	1.65"	1.65"

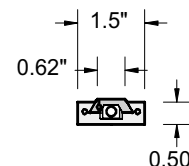

\* (2) 0.125" PLATES & .900" SPACERS

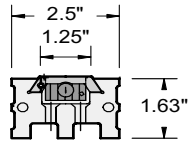
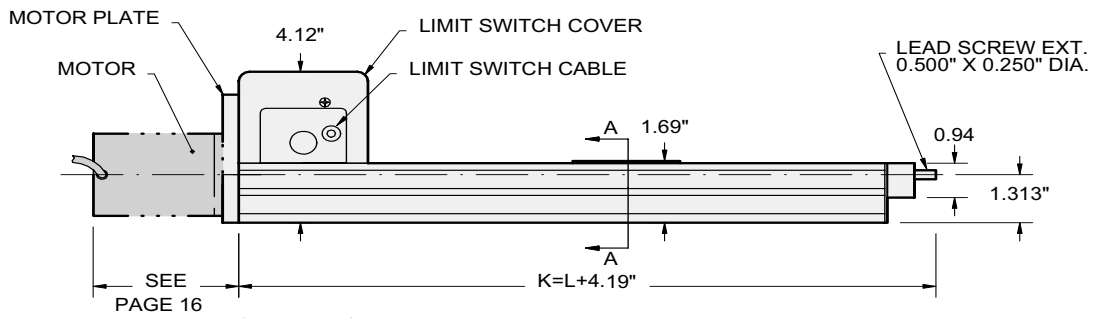
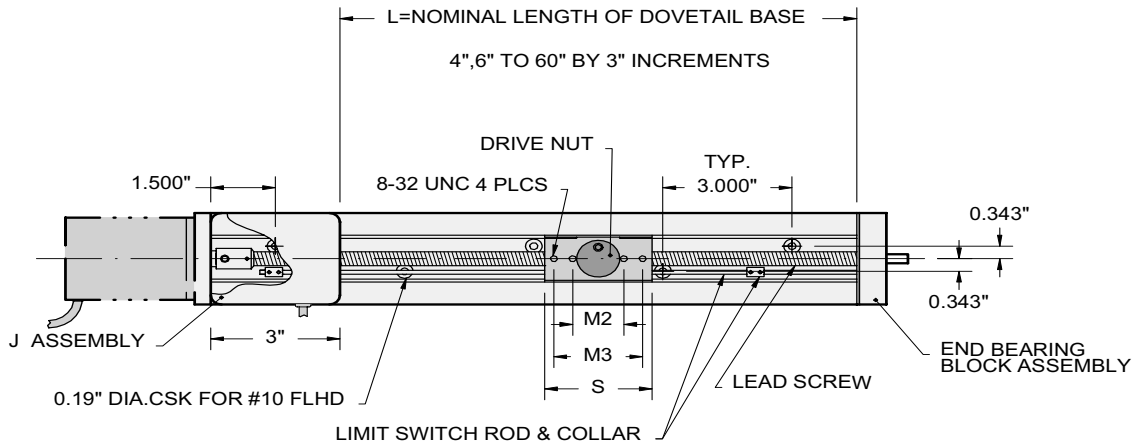

SLIDER LENGTH S	M2	M3
STANDARD 2.50"	1.188"	2.062"
OPTIONAL 3.00"	2.062"	2.562"
OPTIONAL 4.00"	2.062"	3.562"

SECTION A-A

TRAVEL (T) = (L-S)

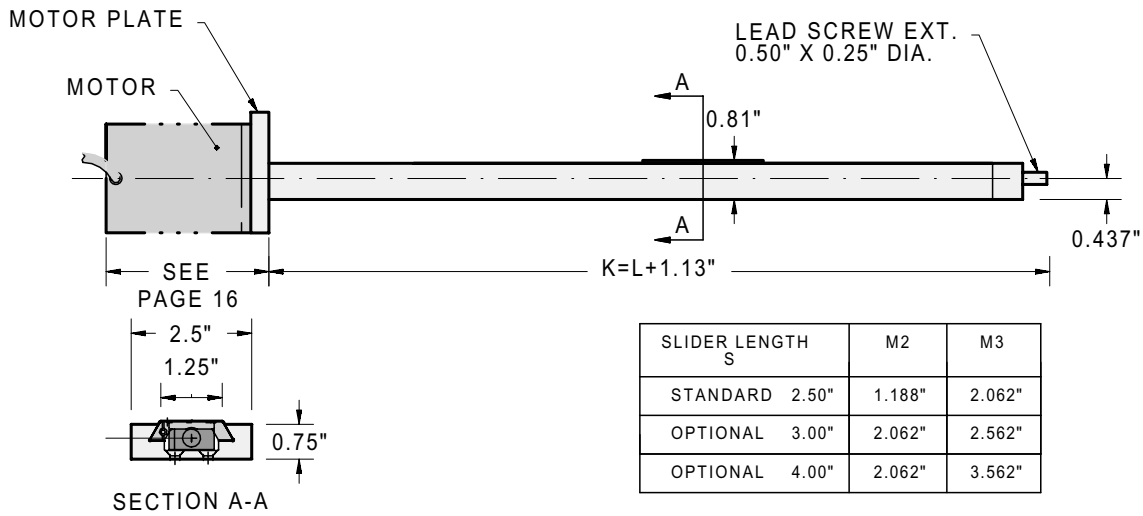
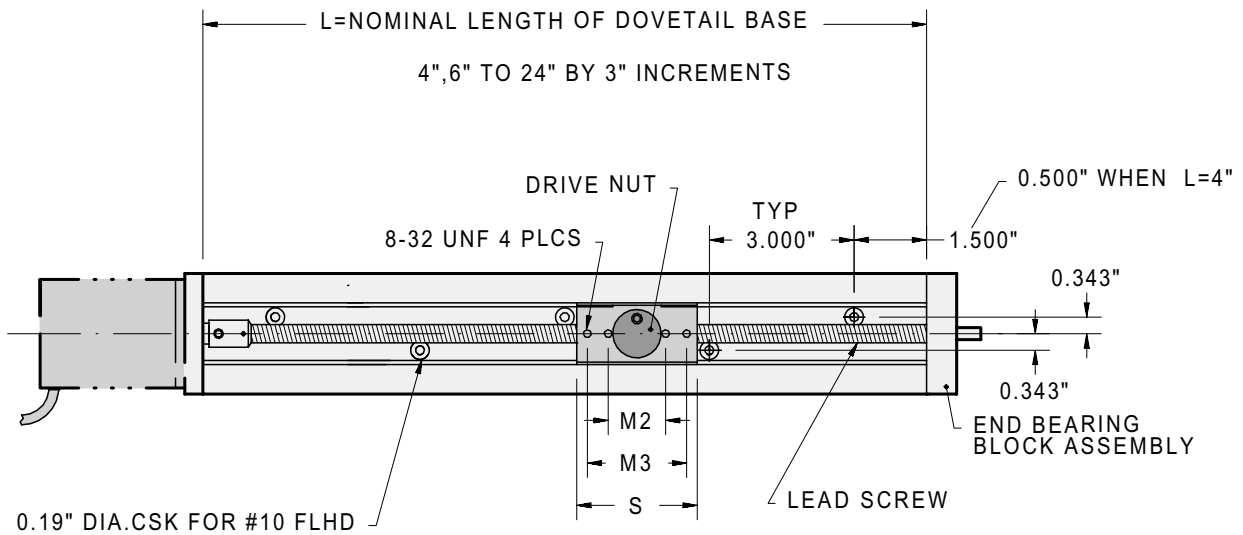

TRAVEL (T) = (L-S) - 1.0"

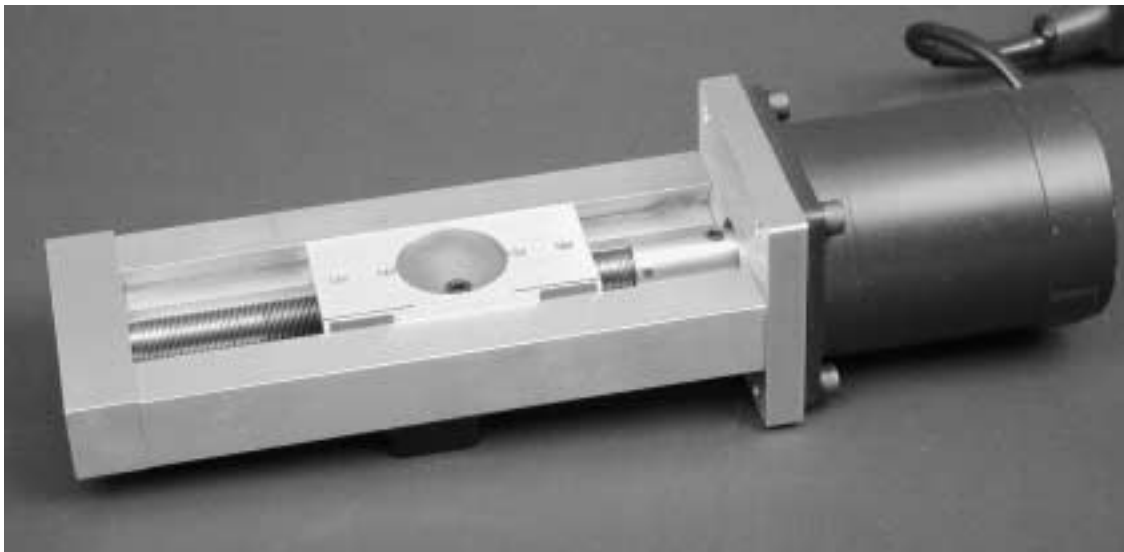

Series MB2500 and MA2500

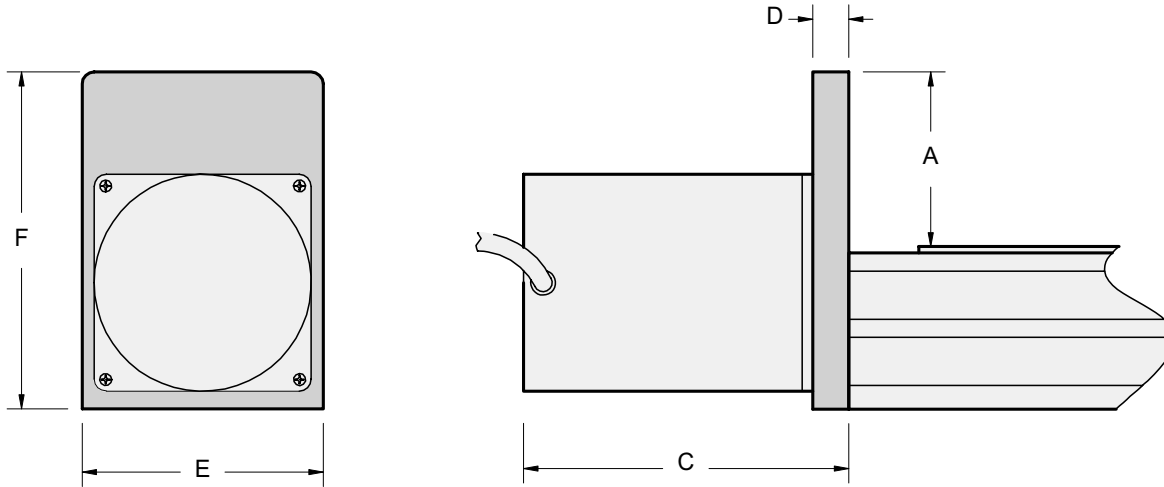

**MB2500**

MOTOR TYPE	A	C	D	E	F
BODINE TYPE K	1.81"	3.40"	0.375"	2.50"	3.50"
PITTMAN GM8000 SERIES	1.81"	3.66"	0.375"	2.50"	3.50"
NEMA TYPE 17 PX245 etc.	1.81"	3.23"	1.375" *	2.50"	3.50"
NEMA TYPE 23T1 MO61-LS08 etc.	1.81"	2.40"	0.375"	2.50"	3.50"
NEMA TYPE 23T2 MO62-LS09 etc.	1.81"	3.40"	0.375"	2.50"	3.50"

OTHER MOTOR OPTIONS AVAILABLE SEE PAGE 35

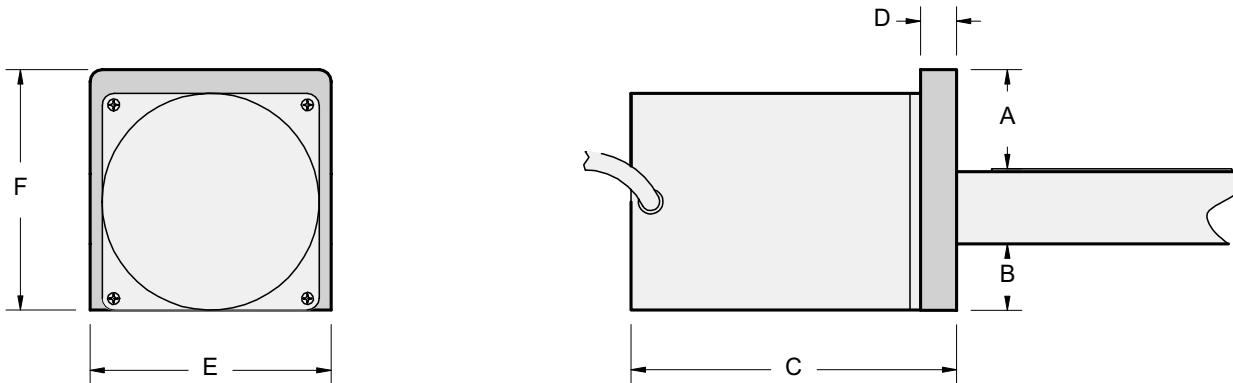

**MA2500**

MOTOR TYPE	A	B	C	D	E	F
PITTMAN GM8000 SERIES	0.38"	0.31"	3.66"	0.375"	2.5"	1.50"
PITTMAN GM9000 SERIES	1.13"	0.31"	4.58"	0.25"	2.5"	2.25"
NEMA TYPE 17 PX245 etc.	0.38"	0.31"	3.23"	1.375" *	2.5"	1.5"
NEMA TYPE 23T1 MO61-LS08 etc.	0.75"	0.69"	2.40"	0.375"	2.5"	2.25"
NEMA TYPE 23T2 MO62-LS09 etc.	0.75"	0.69"	3.40"	0.375"	2.5"	2.25"

\* CONSISTS OF ONE PLATE, 0.375" X 1.5" X 2.5"  
AND ONE BLOCK, 1.0" X 1.5" X 1.5"

OTHER MOTOR OPTIONS AVAILABLE SEE PAGE 35